

KEY TO INDICATIONS

- AIRFIELD PAVEMENTS**
- EXISTING TO BE REMOVED
 - EXISTING NOT USED
 - EXISTING TO BE USED
 - PROPOSED
 - ULTIMATE DEVELOPMENT
- STRUCTURES**
- EXISTING NOT USABLE
 - EXISTING TEMPORARY
 - EXISTING MOBILIZATION
 - EXISTING PERMANENT
 - PROPOSED
 - ULTIMATE DEVELOPMENT
- ROADS & PARKING**
- EXISTING ROADS NOT USABLE
 - EXISTING ROADS USABLE
 - PROPOSED ROADS
 - ROADS - ULTIMATE DEVELOPMENT
 - EXISTING PARKING
 - PROPOSED PARKING
 - PARKING - ULTIMATE DEVELOPMENT
- OTHER**
- BUILDING RESTRICTION LINE
 - EXISTING PROPERTY LINE
 - PROPOSED PROPERTY LINE
 - PROP. LINE ULTIMATE DEVELOPMENT
 - EXISTING RAILROAD
 - PROPOSED RAILROAD
 - EXISTING FENCE
 - PROPOSED FENCE
 - CONTOURS
 - TOP OF SLOPE
 - TOE OF SLOPE
 - CLIFF
 - EXISTING TREE COVERAGE

- COLOR KEY**
- AIRFIELD PAVEMENTS
 - MAINTENANCE, SUPPLY & ORDNANCE
 - OPERATIONS & COMMUNICATIONS
 - HANGARS
 - ADMINISTRATION & TRAINING
 - AIRMEN HOUSING
 - OFFICERS HOUSING
 - NCO FAMILY HOUSING
 - OFF FAMILY HOUSING
 - COMMUNITY
 - RECREATION
 - MEDICAL FACILITIES
 - BODY OF WATER

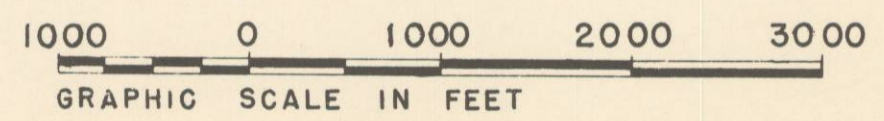
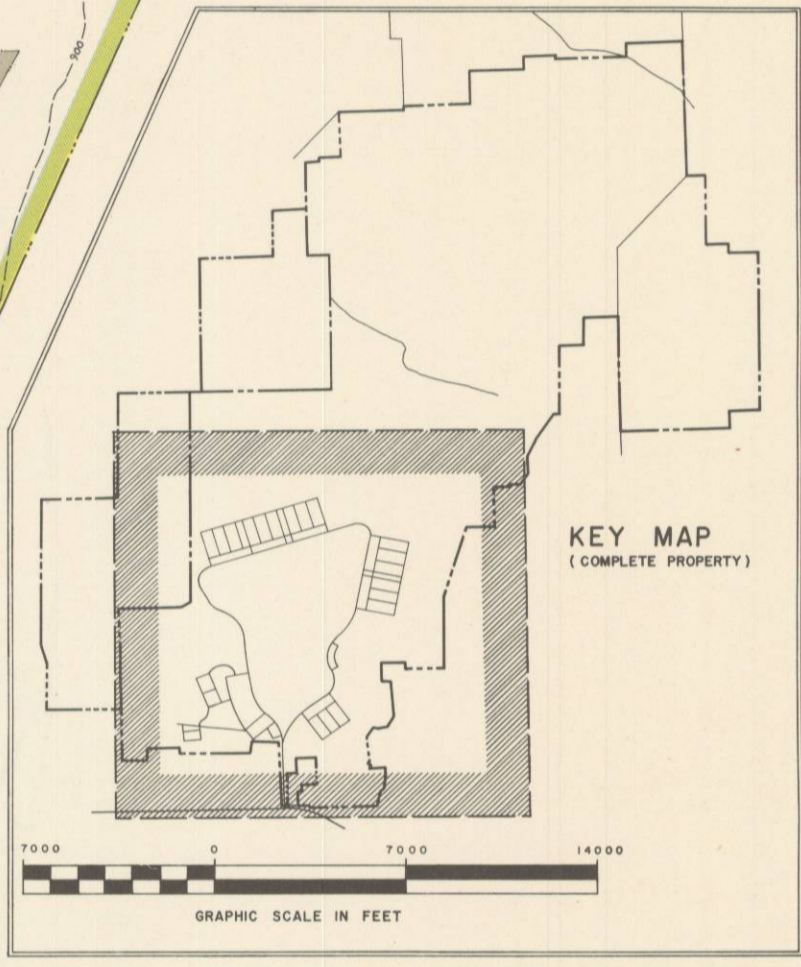

REVISIONS	WOLTERS	
1	AIR FORCE BASE	
2	MINERAL WELLS TEXAS	
3	PRELIMINARY	MASTER PLAN
4		
5		
6		
	MASTER PLANNING DIRECTIVE	DATE OF APPROVAL
	WOLTERS AFB TEXAS	20 AUG. 1951